

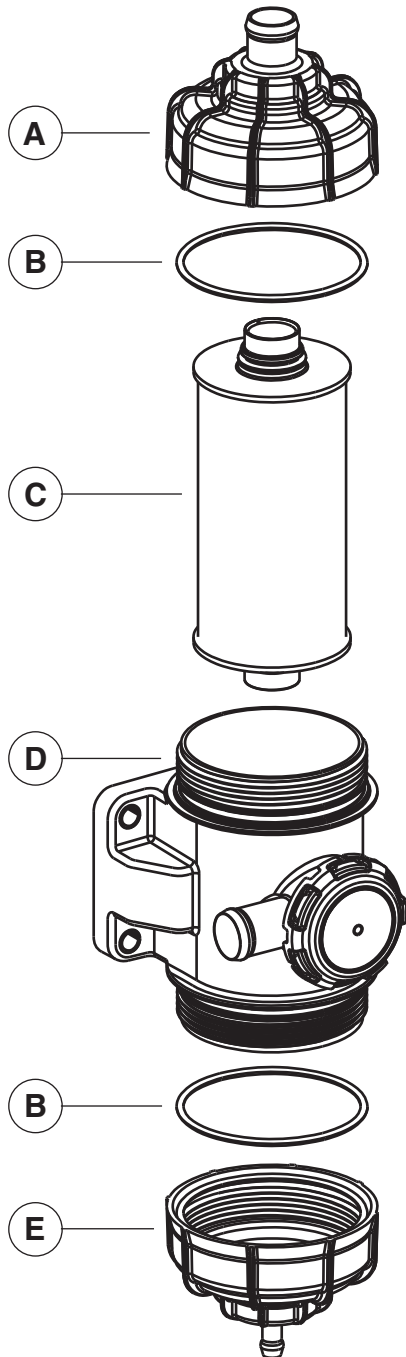

# Crankcase Ventilation Manager (CVM200) Installation Instructions

## CVM200 (CV52036 Shown)



## Parts List

Part	Description	No. Included	Part Number
A	Inlet Cover	1	See Page 6 for Ordering Information
B	O-Ring	2	
C	Element	1	
D	Base	1	
E	Drain Cover	1	

## Additional Materials Required

Description
1" (25 mm) Hose (SAE20R3)
1" (25 mm) Hose Clamps
3/8" (10 mm) Hose (SAE30R7)
3/8" (10 mm) Hose Clamps
3/8" (10 mm) Check Valve (No. Q458222A)
Required (4) M8 or M10 Bolts

## Tools Required

Description
Ratchet and Socket Set
Torque Wrench
Rubber or Cloth Strap Wrench
Hose Cutter

**Note:** Depending on the application, other components and tools may be required for installation.

**CAUTION:** These instructions are intended for use by professional mechanics who are trained in the proper use of power and hand tools, using appropriate safety precautions (including eye protection).

## Introduction

The gases that are vented out through the crankcase are the result of leakage around turbocharger seals and the piston rings in the combustion chamber and are composed of hydrocarbon particles, soot from diesel combustion, engine oil and its contaminants.

The Cummins® Filtration CVM200 coalescer system is designed to remove emissions on a variety of diesel engines. Along with reducing emissions, this system helps to reduce oil consumption, mist, fumes and drips in the engine compartment, resulting in a cleaner and safer operating environment.

In Closed Crankcase Ventilation (CCV) mode, the gases are vented back into the air intake system to be consumed by the combustion process. The CVM200 system is capable of vastly reducing the amount of contaminants circulated back into the air intake for a wide variety of today's diesel engines, keeping the turbocharger and heat exchangers clean and performing well.

**⚠ CAUTION: Use of this product will cause an increase in engine crankcase pressure. The installer is responsible for verification that the application is appropriate and that related crankcase pressure issues will not arise.**

## CVM200 System Installation

This section identifies the installation procedures for the CVM200 System. Please review all the installation procedures before proceeding with the installation.

**⚠ CAUTION: The CVM200 installation requirements MUST be met to maintain full warranty coverage.**

### Locating and Mounting the Assembly

The system must be mounted near the engine at least 6" (15 cm) away from major heat sources like the turbocharger or exhaust manifold. The hardware must not be exposed to temperatures over 257 °F (125 °C).

The "cold side" of the engine is the preferred location for mounting. The CVM200 assembly must be mounted vertically, with drain port DOWN, for proper operation.

The ability to service and access the coalescer system should be taken into consideration when determining your application's mounting location. See Table 1.

Table 1 – Service Heights

Size	Service Height Required	Service Direction (Above/Below Assembly)
CVM200	6.7" (170 mm)	Above
	7.1" (180 mm)	Below

During operation, the coalescer should not exceed a 45° angle from vertical. This ensures the proper draining of oil from the coalescer back into the engine.

In order to drain continuously, the oil in the drain must overcome the crankcase pressure and requires the system to be mounted a certain height above the drainback port location. Drain height should be measured from coalescer drain to top of check valve in the drain line.

See Figure 1 for measurement. See Table 2 for minimum drain height requirements.

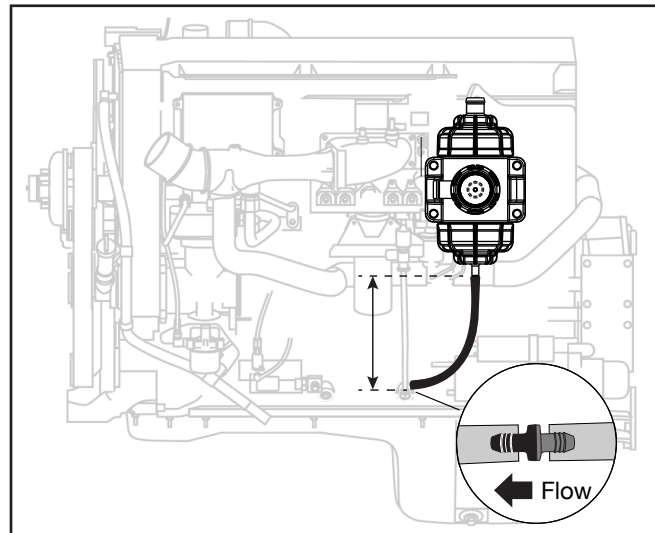

Figure 1 – Measuring Drain Height

Table 2 – Drain Height

Size	Minimum Drain Height (Drain to Check Valve)
CVM200	18.7" (475 mm)

**Note:** All values shown above protect for continuous drain up to 45° engine angularity; for intermittent angularity or flow condition, drain height can be reduced. Contact a Cummins Filtration applications engineer to determine appropriate drain height requirements.

To install:

1. Find a mounting location for the CVM assembly above the engine drain-back port location. Be sure to take both service height and drain height into consideration.
2. Secure the coalescer to engine or bracket using four (4) M8 bolts. Torque each bolt to 15 ft-lbs (20.3 N·m).

## Hose Installation

**Note:** This CVM system requires the three (3) hose connections described below in order to function properly.

### Installing the CVM200 Inlet Hose

The engine's crankcase vent port should be connected to the inlet of the coalescer unit using a 1" (25 mm) ID hose. Use 1" (25 mm) hose clamps to connect. Tighten to secure. See Figure 2.

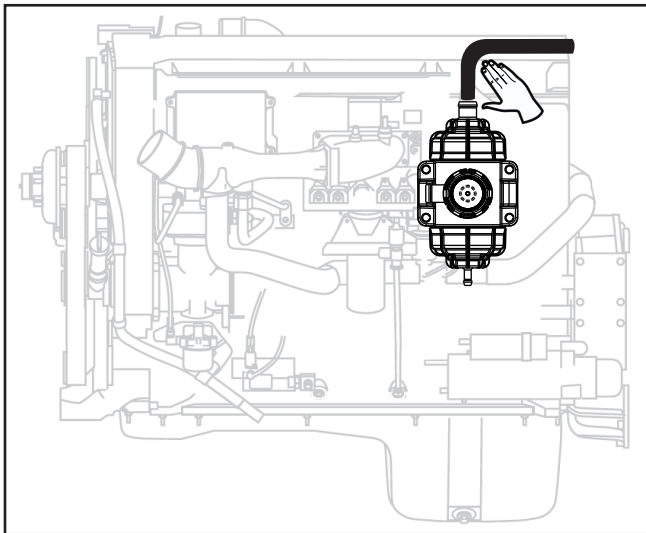

Figure 2 – Connecting to Inlet

### Installing the CVM200 Outlet Hose

The outlet of the CVM system can be routed either to the atmosphere (open system) or back to the engine air intake ducting (closed system). Instructions for both options are included here.

**⚠ CAUTION:** Make sure you are compliant with emission regulations for your locale when deciding to use Open Crankcase Ventilation (OCV) versus Closed Crankcase Ventilation (CCV).

### CVM200 Outlet (Open)

1. Attach a 1" (25 mm) ID hose to the CVM outlet. Ensure the hose is directed downward and trim, if necessary. Secure the loose hose to stabilize. See Figure 3.
2. Use a 1" (25 mm) hose clamp on the hose connection and tighten to secure.

**⚠ CAUTION:** Avoid low spots in hoses. Excessive crankcase pressure can develop as a result of dips or low spots in hoses that allow oil to collect and pool.

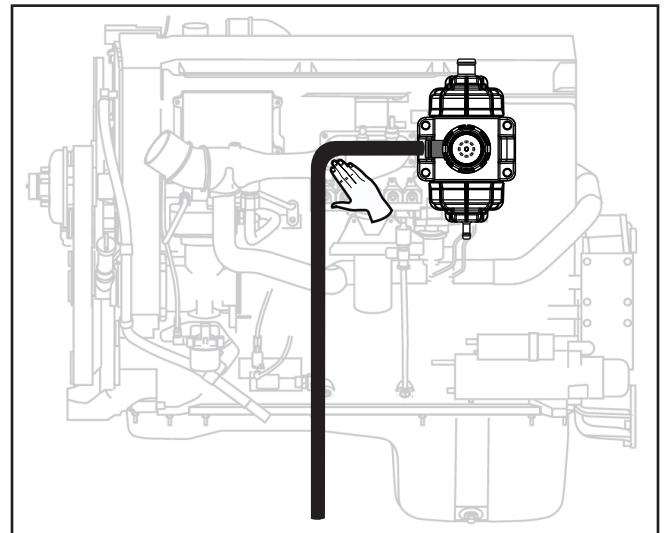

Figure 3 – Connecting to Outlet (Open)

### CVM200 Outlet (Closed)

1. Locate an area downstream of the air filter, but upstream of the turbocharger for the hose connection. The hose can be connected to an unused port, to a T-style connecting coupler, or to a hose barb welded onto a metal section of the air intake ducting. See Figure 4.
2. Attach a 1" (25 mm) ID hose to the CVM outlet. Attach the opposite end of the hose back to the air intake ducting port.
3. Use 1" (25 mm) hose clamps on the hose connections and tighten to secure.

**⚠ CAUTION:** When welding on hose barbs, make sure the welds are leak-free and all the shavings and debris are removed from the intake ducting before starting the engine in order to avoid damage to components.

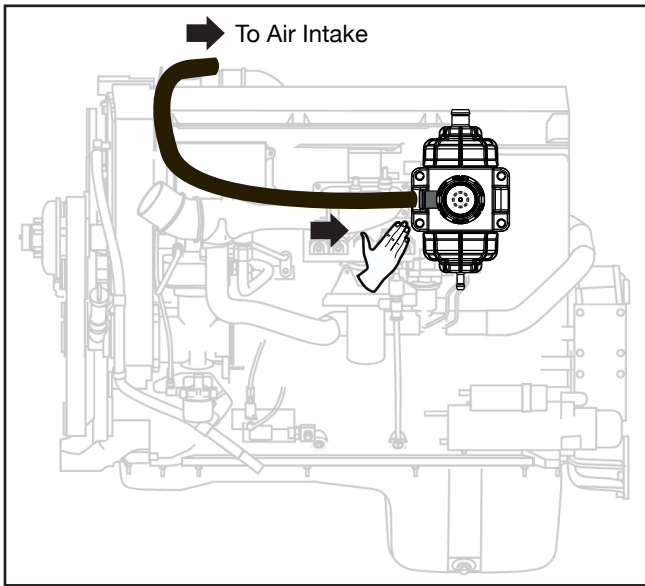

Figure 4 – Connecting to Outlet (Closed)

## Installing the Drain Hose

To ensure adequate drain height, follow the guidelines in Table 2.

A check valve must be installed between the CVM200 system drain and the drain-back port location. Proper orientation of the valve allows flow from the coalescer's drain to the engine, but blocks flow from the engine into the coalescer.

Typical engine drain locations are available on unused low pressure engine block ports, dip-stick holes, or by welding a 3/8" (10 mm) adapter to the oil fill neck. If any other drain location is desired, contact a Cummins® Filtration applications engineer.

1. Attach a 3/8" (10 mm) ID hose to the CVM200 system drain. Attach the other end of the hose to the check valve. Ensure the check valve is oriented properly and in a vertical position. This hose should be long enough so that the check valve is near the drain-back port on the engine. See Figure 5.

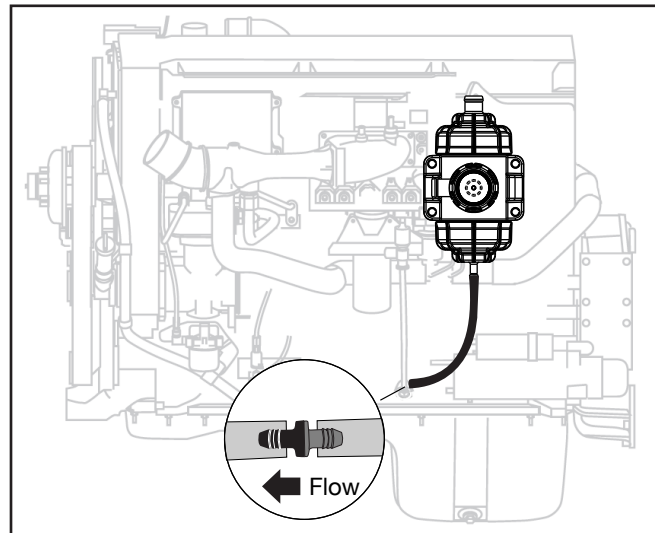

Figure 5 – Connecting to Drain

2. Attach a short piece of 3/8" (10 mm) ID hose to the bottom side of the check valve. Attach the opposite end of the hose to the drain-back port location.
3. Use 3/8" (10 mm) hose clamps on all hose connections and tighten to secure.

**⚠ CAUTION:** Re-inspect the hose and routing to verify it is free of any loops, kinks, or abrupt bends.

**⚠ CAUTION:** Be sure to follow the hose manufacturer's specification when routing the drain line.

**Avoid trimming too short to prevent hose kink after installation.**

## Ensuring the System is Leak-Free

To be fully effective, all the connecting hoses and tubing should be in good condition and leak-free. The system should be inspected regularly for any leaks, damages, or material defects. Those issues should be corrected by replacing damaged parts with new ones.

## Post Installation Check

1. Make sure that all bolts, fasteners, and clamps are tight.
2. Make sure that all hoses are secure.
3. Make certain that drain line height is adequate (see Table 2).
4. Start the engine, allowing it to idle and warm up.
5. Check for leaks in all hose connections.
6. Turn the engine off.
7. Repair all leaks, if found, during checks.
8. Add filter service note to the Service Log.

**⚠ CAUTION:** The oil dip-stick can act as a pressure relief location and become dislodged from its properly installed position. If the dip-stick becomes dislodged, check the coalescer filter to see if it has become plugged or dirty, and replace if necessary.

## System Maintenance

Cummins® Filtration recommends that the coalescer filter be serviced once every year or 2000 hours, whichever comes first, and the vehicle maintenance records should be updated to include a reminder.

Refer to Table 3 for correct service kit.

Table 3 – Service Kits

CVM200 System	Service Kit
CV52035	CV52055
CV52036	CV52055

**⚠ CAUTION:** A filter left unchecked and unchanged can result in lower efficiencies and fouling of the turbocharger and heat exchanger. A plugged filter can also cause high crankcase pressure.

1. Loosen the inlet hose clamp (service from above) or drain hose clamp (service from below).
2. Unthread the cover by hand or with a rubber or cloth strap wrench.
3. Remove the used filter and o-ring from the base. See Filter Disposal Information (next section) for proper handling of the used filter and o-ring.

4. Lubricate the new housing o-ring with clean engine oil. Install the new o-ring onto the reusable base.
5. Tighten the reusable cover onto the assembly by hand.
6. Use a rubber or cloth strap wrench to fully secure the cover. Tighten until the cover touches the flange of the base. See Figure 6.

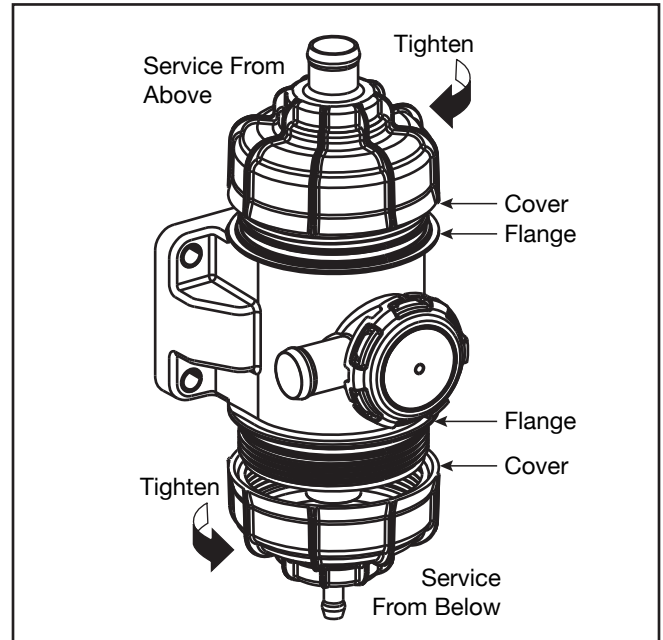

Figure 6 – Tightening the Cover(s)

7. Perform a Post Installation Check.

## Filter Disposal Information

During normal use, the coalescer's filter collects engine oil, diesel particles, engine wear debris and by-products of combustion. Please dispose of used coalescer filters per local regulations. Treating the used coalescer filter in the same manner as a used oil filter can usually meet local regulations.

## CVM200 Ordering Information

Part Number	Description
CV52035	Outlet at 3 O'Clock
CV52036	Outlet at 9 O'Clock

## CVM200 Specifications

Specification	CVM200
Height Overall	10.50" (266.6 mm)
Depth Overall	5.42" (137.66 mm)
Width Overall	5.71" (145 mm)
Nominal Flow	3.53 ft <sup>3</sup> /min (100 L/min)
Efficiency at Nominal Flow (Dry)	>98 %
Restriction at Nominal Flow (Dry)	1.85" H <sub>2</sub> O (0.46 kPa)
Restriction at Nominal Flow (Saturated)	4.53" H <sub>2</sub> O (1.13 kPa)
Maximum Flow	7.06 ft <sup>3</sup> /min (200 L/min)
Restriction at Max Flow (Dry)	4.13" H <sub>2</sub> O (1.03 kPa)
Restriction at Max Flow (Saturated)	10.51" H <sub>2</sub> O (2.62 kPa)

## CVM200 Outlet Orientations

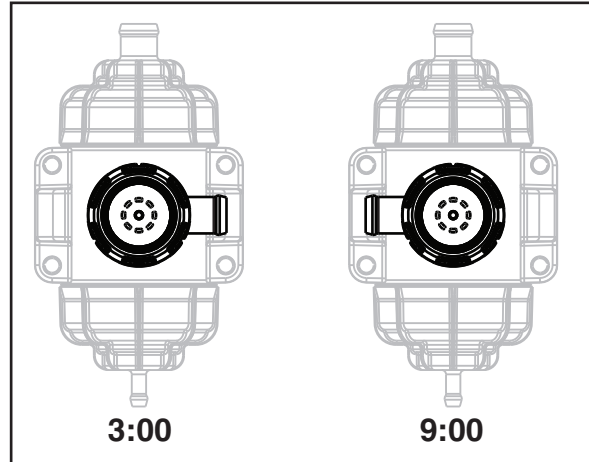

## CVM200 Mounting/Dimensions

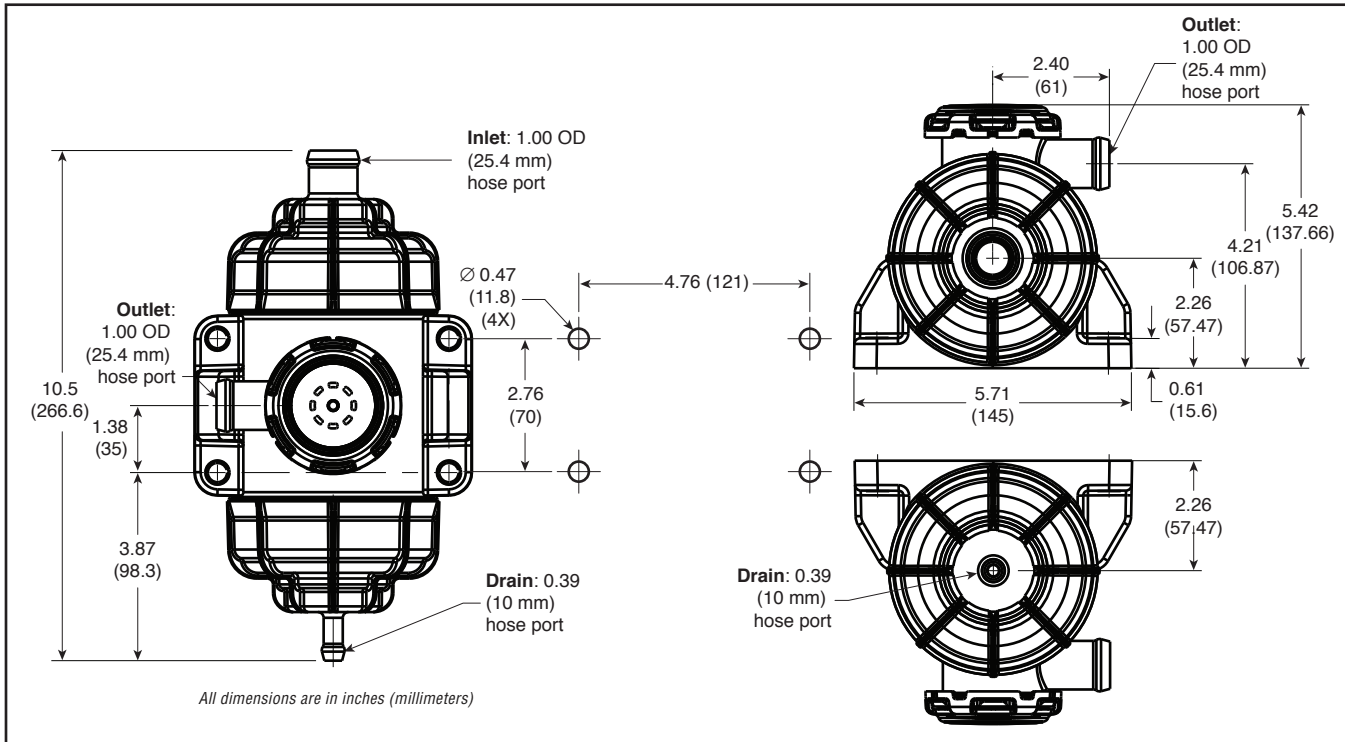

**Filtration**

For more information, visit [cumminsfiltration.com](http://cumminsfiltration.com)

LT36220  
©2011 Cummins Filtration Inc.  
Printed in the U.S.A.