

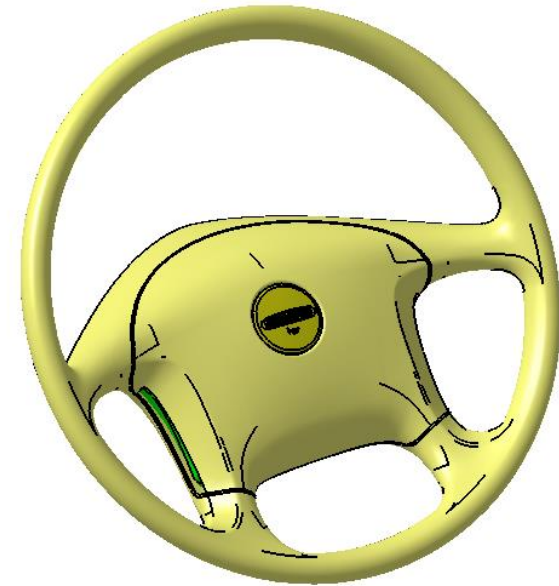

Feature(s) on this drawing are subject to the Safety-Relevant Characteristic Policy 09ENG-PROC008

RELEASE NUMBER	REV LTR	REVISION DESCRIPTION	BY	DATE	APPD
P22553-02	-	INITIAL RELEASE	AVC	08/24/05	NER
P59038-05	A	1. REDRAWN AND REMASTERED 2. UPDATE SAFETY CRITICAL TORQUE SPECS	NTN	04/02/19	RPW



1. PRIOR TO ASSEMBLING THE STEERING WHEEL TO THE STEERING COLUMN, THE STEERING SYSTEM SHOULD BE CONNECTED AND ADJUSTED. IMPLYING THAT THE TOE-IN IS ADJUSTED WITHIN THE RECOMMENDED RANGE, THE PITMAN ARM IS ALIGNED WITH THE PROPER TIMING MARK, THE DRAG LINK IS INSTALLED AND ADJUSTED TO THE PROPER LENGTH, AND THE UNIVERSAL SHAFT IS SECURED TO THE STEERING GEAR AND STEERING COLUMN.
2. SET THE FRONT TIRES IN THE STRAIGHT FORWARD POSITION.
3. INSTALL THE STEERING WHEEL TO THE STEERING COLUMN SO THAT THE STEERING WHEEL SPOKES ARE WITHIN 5 DEGREES OF STRAIGHT AHEAD POSITION.
4. FASTENER TORQUE CALLED OUT IN BILL OF MATERIAL
5. CONNECT HORN UPLEAD WIRES FROM STEERING COLUMN TO HORN BUTTON AND INSERT HORN BUTTON MODULE INTO STEERING WHEEL.

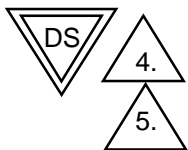

ITEM NUMBER D14-16396	DESCRIPTION DIAG-INSTL, WHEEL, STEERING	DAIMLER		Daimler Trucks North America			
		THE INFORMATION CONTAINED HEREIN IS PROPRIETARY DATA, AND IS NOT FOR DISSEMINATION OR DISCLOSURE, IN WHOLE OR IN PART, FOR ANY PURPOSE OTHER THAN THAT FOR WHICH IT IS SUBMITTED, EXCEPT AS AUTHORIZED IN WRITING BY DAIMLER TRUCKS NORTH AMERICA LLC (DTNA)					
		MATERIAL APPROVAL N. RITCHIE		DATE 08/24/05		UNLESS OTHERWISE NOTED, DIMENSIONS AND TOLERANCES ARE DEFINED ACCORDING TO ASME Y14.5M- 1994, WITH EXCEPTION PER DTNA 09ENG-WI037	
		DRAWN BY A.CASE		DATE 08/24/05			
CHECKED BY N. RITCHIE		DATE 08/24/05					
RESPONSIBLE ENGINEER A.CASE		DATE 08/24/05					
APPROVED BY B. LILLEY		DATE 08/24/05		THIRD ANGLE PROJECTION			
DIAG-INSTL, WHEEL, STEERING							
SUPPLEMENTAL DESCRIPTION 540D1							

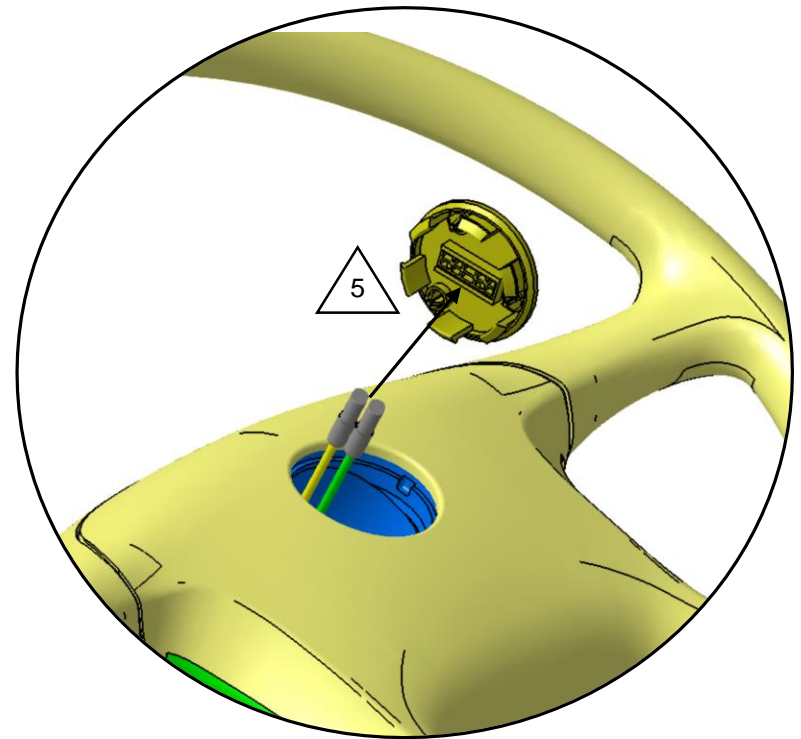
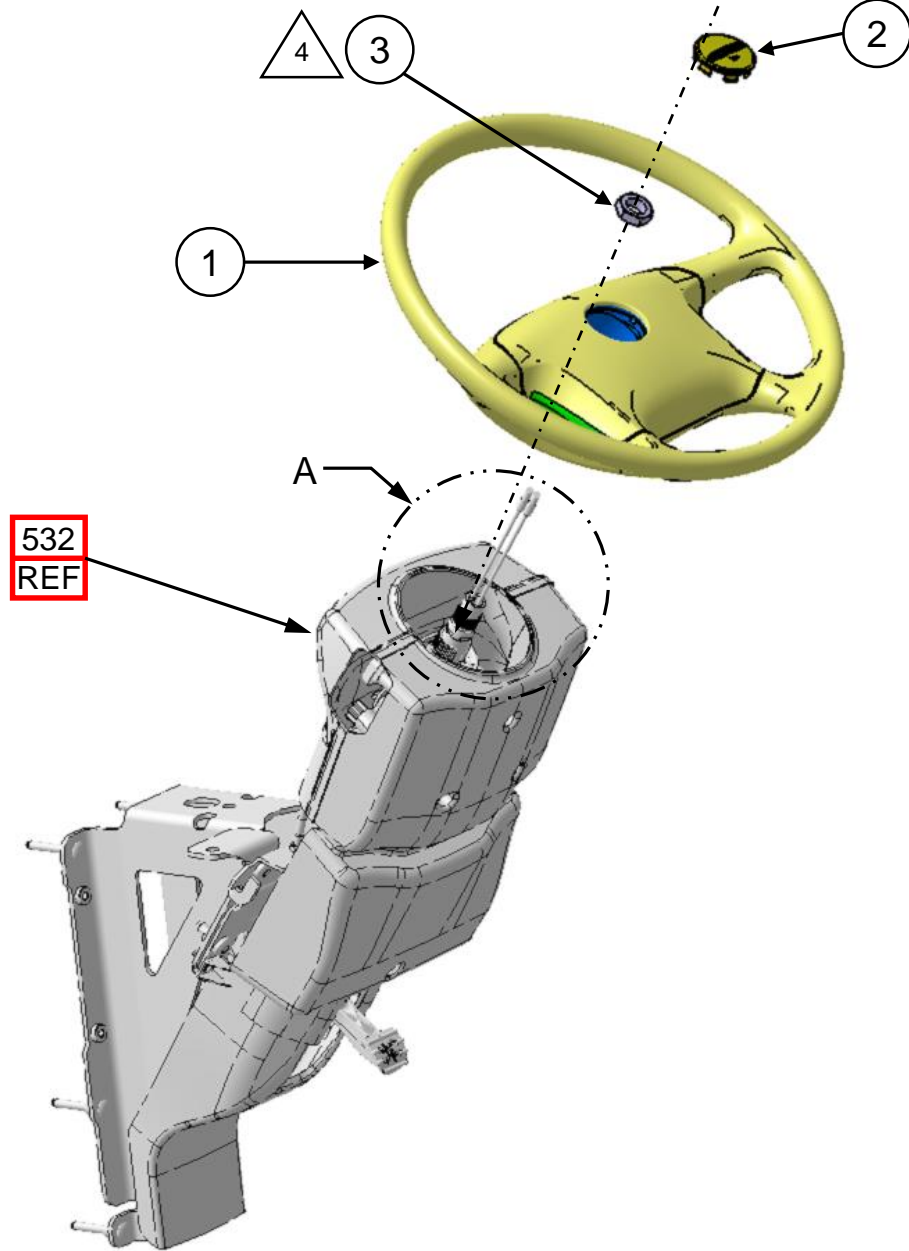

VIEW A