

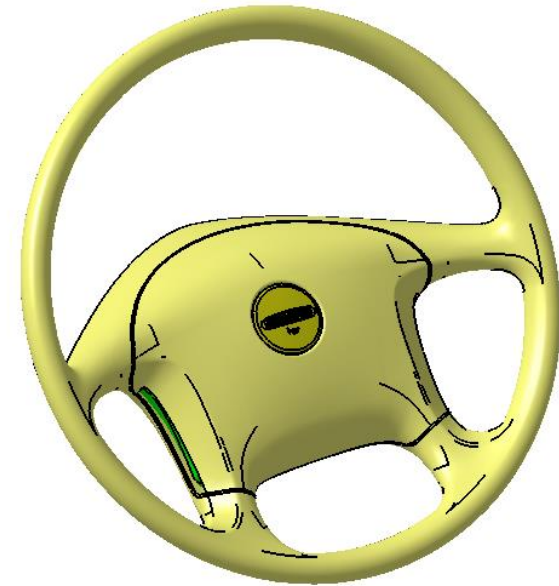

Feature(s) on this drawing are subject to the Safety-Relevant Characteristic Policy 09ENG-PROC008

RELEASE NUMBER	REV LTR	REVISION DESCRIPTION	BY	DATE	APPD
P2A362-47	-	INITIAL RELEASE	GPH	10/03/95	NZ
P59038-05	A	1. REDRAWN AND REMASTERED 2. UPDATE SAFETY CRITICAL TORQUE SPECS	NTN	04/02/19	RPW



1. PRIOR TO ASSEMBLING THE STEERING WHEEL TO THE STEERING COLUMN, THE STEERING SYSTEM SHOULD BE CONNECTED AND ADJUSTED. IMPLYING THAT THE TOE-IN IS ADJUSTED WITHIN THE RECOMMENDED RANGE, THE PITMAN ARM IS ALIGNED WITH THE PROPER TIMING MARK, THE DRAG LINK IS INSTALLED AND ADJUSTED TO THE PROPER LENGTH, AND THE UNIVERSAL SHAFT IS SECURED TO THE STEERING GEAR AND STEERING COLUMN.
2. SET THE FRONT TIRES IN THE STRAIGHT FORWARD POSITION.
3. INSTALL THE STEERING WHEEL TO THE STEERING COLUMN SO THAT THE STEERING WHEEL SPOKES ARE WITHIN 5 DEGREES OF STRAIGHT AHEAD POSITION.
4. FASTENER TORQUE CALLED OUT IN BILL OF MATERIAL
5. CONNECT HORN UPLEAD WIRES FROM STEERING COLUMN TO HORN BUTTON AND INSERT HORN BUTTON MODULE INTO STEERING WHEEL.

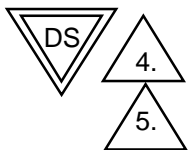

ITEM NUMBER D14-12762-000	DESCRIPTION INST-STEERING WHEEL, FIXED COL.	DAIMLER		Daimler Trucks North America			
		THE INFORMATION CONTAINED HEREIN IS PROPRIETARY DATA, AND IS NOT FOR DISSEMINATION OR DISCLOSURE, IN WHOLE OR IN PART, FOR ANY PURPOSE OTHER THAN THAT FOR WHICH IT IS SUBMITTED, EXCEPT AS AUTHORIZED IN WRITING BY DAIMLER TRUCKS NORTH AMERICA LLC (DTNA)					
		MATERIAL APPROVAL			DATE		
		DRAWN BY G. HARVEY			DATE 10/03/95		
		CHECKED BY XXX			DATE 11/30/95		
RESPONSIBLE ENGINEER P.M. LOUGH			DATE 10/03/95				
APPROVED BY N. ZAMANI			DATE 10/03/95				
DESCRIPTION			UNLESS OTHERWISE NOTED, DIMENSIONS AND TOLERANCES ARE DEFINED ACCORDING TO ASME Y14.5M-1994, WITH EXCEPTION PER DTNA 09ENG-WI037				
			THIRD ANGLE PROJECTION		UNITS OF MEASURE MM		
INST-STEERING WHEEL, FIXED COL.							
SUPPLEMENTAL DESCRIPTION PREM 2							

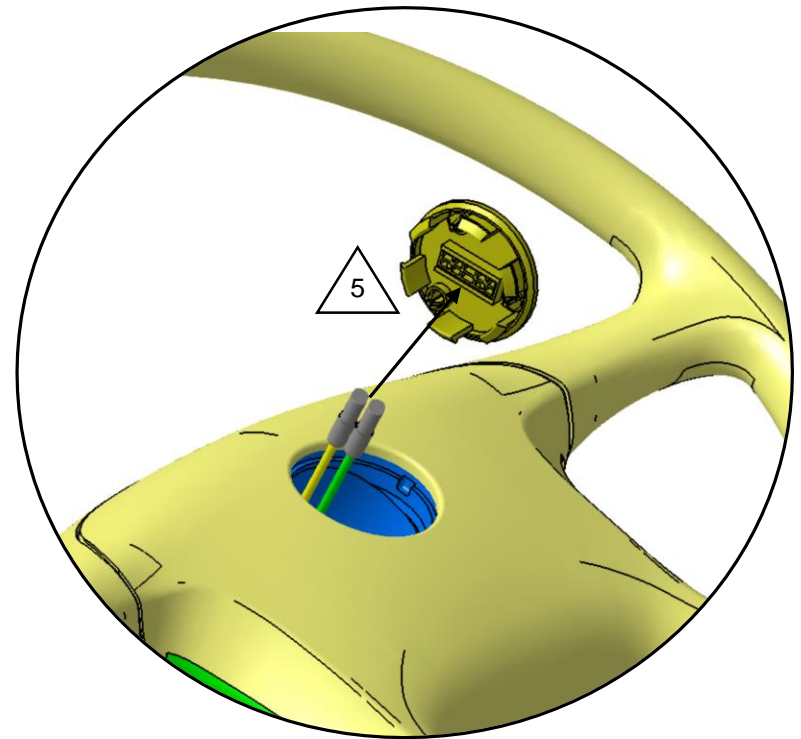
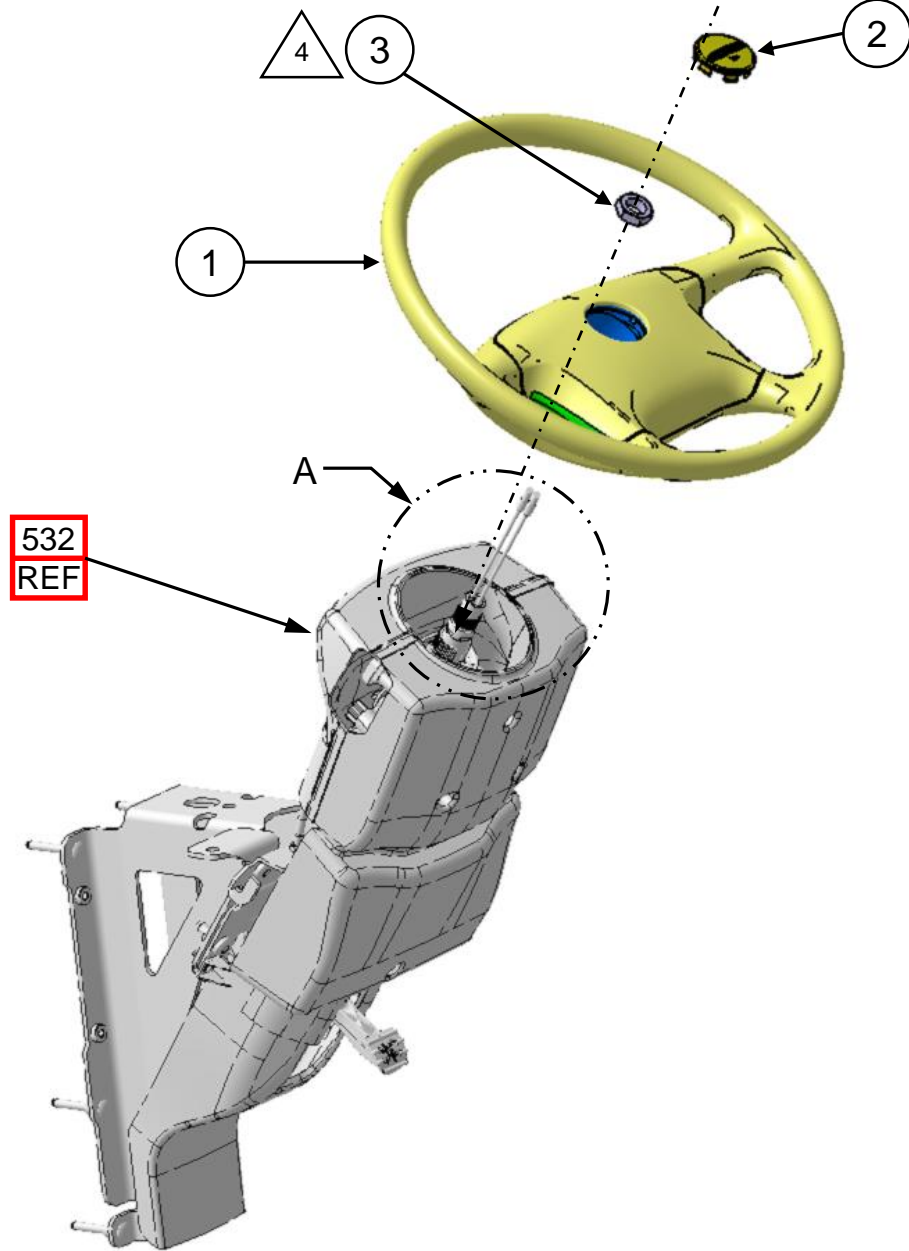

VIEW A